

# Doro 5516

## Quick Start Guide

English

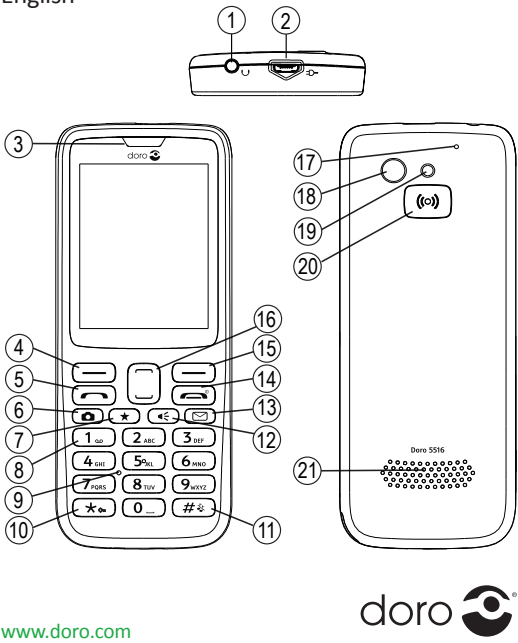

1. Headset socket

2. Charging socket

3. Earpiece

4. Left selection button

5. Call button

6. Camera shortcut

7. Top 10 shortcut

8. Voice mail

9. Microphone

10. Keypad lock/International prefix/Symbols

11. Input method/Silent
12. Torch shortcut

13. Message shortcut

14. End call / Power on/off

15. Right selection button

16. Arrow buttons/navigation keys

17. Second microphone

18. Camera lens

19. Camera flash/Torch

20. Assistance button

21. Loudspeaker

22. Charging stand

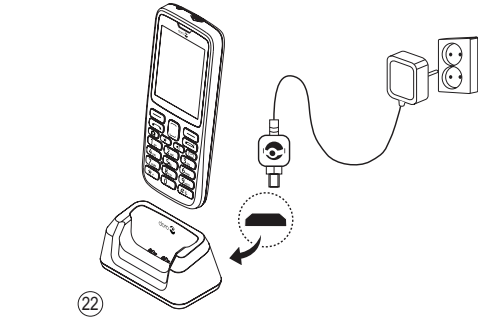

### 1. GET STARTED

**Note!** All illustrations are for illustrative purposes only and may not accurately depict the actual device. The items supplied with your phone might vary depending on the software and accessories available in your region or offered by your service provider. You can obtain additional accessories from your local Doro dealer. The supplied accessories provide the best performance with your phone.

#### Full user manual

For the full user manual, useful links and more information please visit [www.doro.co.uk/support/](http://www.doro.co.uk/support/) or contact our Helpline.

#### SIM card, memory card and battery

##### Remove the battery cover

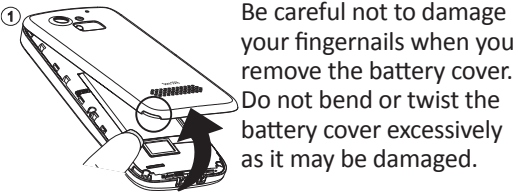

Be careful not to damage your fingernails when you remove the battery cover. Do not bend or twist the battery cover excessively as it may be damaged.

##### Insert the SIM card (required)

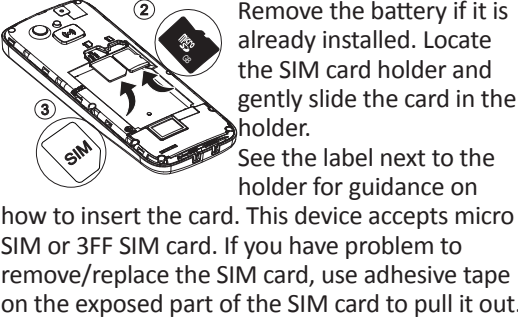

Remove the battery if it is already installed. Locate the SIM card holder and gently slide the card in the holder. See the label next to the holder for guidance on

how to insert the card. This device accepts micro SIM or 3FF SIM card. If you have problem to remove/replace the SIM card, use adhesive tape on the exposed part of the SIM card to pull it out.

##### Insert the SD card (optional)

Locate the SD card holder and gently slide the card in the holder. The device works with or without a SD card installed. Compatible card type: microSD, microSDHC.

##### Replace the battery cover

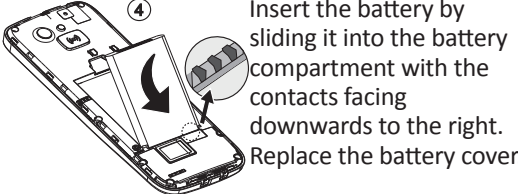

Insert the battery by sliding it into the battery compartment with the contacts facing downwards to the right. Replace the battery cover.

### Charge the phone

#### CAUTION

Only use batteries, charger and accessories that have been approved for use with this particular model. Connecting other accessories may be dangerous and may invalidate the phone's type approval and guarantee.

When the battery is running low, is displayed and a warning signal is heard.

- Connect the mains adapter to a wall socket and to the charging socket or place the device in the cradle. Alternatively connect the cable to the charging socket on the phone and to a USB port on a computer.

### 2. GET TO KNOW YOUR PHONE

#### Turn the phone on and off

- Press and hold the red button on the phone to turn it on/off. Confirm with **Yes** to power off.
- If the SIM card is valid but protected with a PIN code (Personal Identification Number), **PIN** is displayed. Enter the PIN code and press **OK**. Delete with **Clear**.

**Note!** If PIN and PUK codes were not provided with your SIM card, please contact your service provider.

**Tip:** It is recommended to remove the protective plastic film from the display to enhance the visibility.

#### Move contacts from old phone to your new phone

Assuming you will use the same SIM card, copying contacts to your new Doro is pretty straightforward. The steps for copying the contact list depend on your old phone. You might need the manual for the old phone. Make sure that your contacts are stored to the SIM card by copying from phone to SIM card.

Once you have copied your contacts onto the SIM card move the card from your old phone to your Doro 5516.

- Press **Menu** ➔ **Phonebook**, and select a contact and press **Options**.
- Scroll to **Copy all**, press **OK**.
- Press **From SIM**, confirm with **Yes**.

#### Start-up wizard

When starting the telephone for the first time, you can use the start-up wizard to set some basic settings.

**Tip:** You can run the start-up wizard later if you want.

#### Navigate the phone

When the phone is ready to use, and you have not keyed in any characters, the phone is in standby (idle mode).

- Press to return to standby mode.
- Press left selection button to access the phone **Menu** or right selection button **Name** to access your saved contacts in the phonebook.
- Press the arrow buttons , to scroll and to select.

**Tip:** You can always press to return to standby.

#### Enter text

- Press a numerical key repeatedly until the desired character is shown. Wait a few seconds before entering the next character.

- Press for a list of special characters. Select the desired character with , and press **OK** to enter it.
- Use , to move the cursor within the text.
- Press to cycle upper case, lower case and numerals.
- Press and hold to change writing language.

#### Predictive text

Predictive text suggests words whilst you write text messages, available only for some languages.

- Press **Menu** ➔ **Settings** ➔ **Messages** ➔ **Predictive text**.
- Select **Off** to disable the predictions.
- Press **OK** to confirm.

#### Volume control

Use , to adjust the sound volume during a call. The volume level is indicated on the display.

#### Silent

Silent is a fixed profile with keypad tone, message tone and ring tone disabled, while vibration, tasks and alarm are unchanged.

- Press and hold to activate and to deactivate silent.

### 3. CALLS

#### Make a call

- Enter the telephone number. Erase with **Clear**.
- Press to dial. Press **Abort** to cancel the call.
- Press to end the call.

**Note!** For international calls, always use + before the country code for best operation. Press twice for the international prefix +.

#### Call from the phonebook

- Press **Name** to open the phonebook.
- Use , to scroll through the phonebook, or quick search by pressing the key corresponding to the first letter of the name.
- Press **Options** ➔ **Call**, alternatively, press to dial the selected entry, or press **Back** to return to standby.

#### Receive a call

- Press to answer, or press **Silent** to switch off the ring signal and then **Reject** to reject the call (busy signal). Alternately, press to reject the call directly.
- Press to end the call.

#### Call options

During a call the selection buttons () give access to additional functions.

#### Speed dial

Use **0** and **2-9** to speed dial an entry from standby.

#### Setup Speed dials

- Press **Menu** ➔ **Settings** ➔ **Phonebook** ➔ **Speed dial**.

### 4. SOUND & DISPLAY

#### Tone setup

- Press **Menu** ➔ **Settings** ➔ **Sound** ➔ **Tone setup** ➔ **Ringtone**.
- Use , to select a melody, the selected melody is played.

- Press **OK** to confirm or **Back** to discard changes.

#### Text size

You can customise the text size for the menu and messages.

- Press **Menu** ➔ **Settings** ➔ **Display** ➔ **Text size**:
  - Normal** or **Large**.
- Press **OK** to confirm.

#### Brightness

You can customise the brightness settings. The higher value, the better contrast.

- Press **Menu** ➔ **Settings** ➔ **Display** ➔ **Brightness**:
  - Level 1-3**.
- Press **OK** to confirm.

### 5. SOS CALLS

As long as the phone is switched on, it is always possible to place an SOS call by entering the main local emergency number for your present location followed by .

### 6. CALL LOG

Received, missed, and dialled calls are saved in a combined call log. 20 calls of each type can be stored in the log. For multiple calls related to the same number, only the most recent call is saved.

- Press to find your call log.
- Use , to scroll through the call log.

- = Received call
- = Dialled call
- = Missed call
- Press to dial, or **Options**.

### 7. PHONEBOOK

#### Add contact

- Press **Menu** ➔ **Phonebook** ➔ **-New contact-** ➔ **Add**.
- Enter **Name**. Erase with **Clear**.
- Use , to select **Mobile**, **Home** or **Office**, and enter the phone number(s) including the area code.
- When done, press **Save**.

#### 8. ICE (IN CASE OF EMERGENCY)

In the event of a trauma, it is critical to have this information as early as possible to increase the chances of survival. Add ICE contact to improve your own safety. First responders can access additional information such as medication and next of kin from your phone in case of an emergency. All fields are optional, but the more information provided the better.

- Press **Menu** ➔ **Phonebook** ➔ **ICE**.
- Use , to scroll the entries.
- Press **Edit** to add or edit information in each entry. Delete with **Clear**.
- Press **Save** when done.

### 9. ASSISTANCE BUTTON

The assistance button allows easy access to contact your predefined help numbers should you need help. Make sure that the assistance function is activated before use. See the full manual on how to activate, how to enter recipients in the numbers list, and how to edit the text message.

#### Make an assistance call

- When help is needed, press and hold the assistance button for 3 seconds, or press it twice within 1 second. The assistance call begins after a delay of 5 seconds. In this time you can prevent a possible false alarm by pressing .

#### CAUTION

When an assistance call is activated the phone is pre-set to handsfree mode. Do not hold the device near your ear when the handsfree mode is in use, because the volume may be extremely loud.

#### Assistance button settings

- Press **Menu** ➔ **Settings** ➔ **Assistance**.

### 10. MESSAGES

#### Create and send messages

- Press shortcut button , or press **Menu** ➔ **Messages** ➔ **Create new**.
- Select **Create new** to select **SMS**, **MMS**, **Voice message** or **Email** (before sending an email for the first time you need to create an account).

**Note!** To keep best picture quality, send only one picture per MMS.

#### Create and send e-mail

Doro 5516 can be set to download only the e-mail header, which includes the sender and the subject of the e-mail.

#### Create e-mail account

- Press **Menu** ➔ **Messages** ➔ **E-mail**.
- Select **Yes** and follow the instructions.

#### Download e-mail

- Press **Menu** ➔ **Messages** ➔ **E-mail** ➔ **Inbox** to download e-mails.

#### Message settings

- Press **Menu** ➔ **Settings** ➔ **Messages** ➔ for additional settings. See more information in the complete manual.

E-mail accounts, like Gmail and Yahoo require you to change an account setting before you are able to access emails on your new Doro phone. To avoid problems signing in, you may need to log-into your Gmail / Yahoo account. Please use the following process to activate the use of your account on your Doro phone or you may receive a ‘pop up’ message that the ‘authentication process has failed’.

#### Gmail & Yahoo Mail:

- Use a computer / tablet web browser to log in to your Gmail/Yahoo account.
- Click your name (top right corner) ➔ **My Account** ➔ (Under the security section click) **Connected apps & sites/ Account security** ➔ **Allow less secure apps** ➔ Set the switch to **ON**.
- Try to log in with your device again.





Gmail still not working?

1. Use a computer web browser to log in to your Gmail account.
2. Use the shortcut link : <https://accounts.google.com/b/0/DisplayUnlockCaptcha>
3. Click **Continue**.
4. Try to log in with your device again.
- 

11. CAMERA

You can take photos, record videos and view your photos and videos.

1. Press shortcut button . Alternatively press **Menu ➔ Camera**.
2. Press  to take the photo.
3. Press **Options** or press **Back** to save and to take a new photo (the photo is saved even if you don’t make any selection).

Camera settings

- Press **Menu ➔ Settings ➔ Camera**.

12. BLUETOOTH®

You can connect wirelessly to other Bluetooth compatible devices such as headsets or other phones.

Activate Bluetooth

1. Press **Menu ➔ Settings ➔ Connectivity ➔ Bluetooth ➔ Activation ➔ On**.
2. Press **OK** to confirm.

Search device

1. Press **Menu ➔ Settings ➔ Connectivity ➔ Bluetooth ➔ Search device**.
2. Select a device from the list and press **Pair** to connect. If Bluetooth is not enabled, press **Yes** to activate.
3. When connecting to another Bluetooth device you need a shared password. Enter the password and press **OK**.

13. TORCH





1. Press **Menu ➔ More ➔ Torch**.
2. Select **Off** to turn off.

**Tip:** Press and hold shortcut button  to turn on the torch. Release to turn off.

14. INTERNET

Use the web browser to access the Internet.

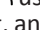
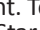
1. Press **Menu ➔ Internet**.
2. Select **Browser**.

In order to navigate the Browser, scroll up and down with the buttons ,  use the Camera button  to scroll to the left, and the Message button  to scroll to the right. To select an object or click a link, use the Star button .

15. WEATHER

**Note!** In order to see the weather forecast, you must first enter the name for your desired city/location. Press **OK** to display a list of the possible locations. Select your desired city / location.

**To view the weather forecast for your chosen city**

1. Press **Menu ➔ Weather**.
2. Press **Back** to return to standby mode.

Settings

- Press **Menu ➔ Settings ➔ Weather** for additional settings.

**Important!**  
The features Internet and Weather uses data services and using data services can be costly. We recommend that you check your data service rates with your service provider.

16. SAFETY INSTRUCTIONS

 **WARNING**  
The unit and the accessories can contain small parts. Keep all of the equipment out of the reach of small children. The mains adapter is the disconnect device between the product and mains power. The mains socket outlet must be close to the equipment and easily accessible.

Network services and costs

Your device is approved for use on the WCDMA 900/2100 MHz, GSM 900/1800/1900 MHz networks. To use the device, you need a subscription with a service provider. Using network services may result in traffic costs. Some product features require support from the network, and you may need to subscribe to them.

Operating environment

Follow the rules and laws that apply wherever you are, and always turn off the unit whenever its use is prohibited or can cause interference or hazards. Only use the unit in its normal user position.  
Parts of the unit are magnetic. The unit can attract metal objects. Do not keep credit cards or other magnetic media near the unit. There is a risk that information stored on them can be erased.

Medical units

The use of equipment that transmits radio signals, for example, mobile phones, can interfere with insufficiently protected medical equipment. Consult a doctor or the manufacturer of the equipment to determine if it has adequate protection against external radio signals, or if you have any questions. If notices have been put up at health care facilities instructing you to turn off the unit while you are there, you should comply. Hospitals and other health care facilities sometimes use equipment that can be sensitive to external radio signals.

Implanted medical devices

To avoid potential interference, manufacturers of implanted medical devices recommend a minimum separation of 15 cm between a wireless device and the medical device. Persons who have such devices should:

- Always keep the wireless device more than 15 cm from the medical device.
  - Not carry the wireless device in a breast pocket.
  - Hold the wireless device to the ear opposite the medical device.
- If you have any reason to suspect that interference is taking place, turn the phone off immediately. If you have any questions about using your wireless device with an implanted medical device, consult your health care provider.

Areas with explosion risk

Always turn off the unit when you are in an area where there is a risk of explosion. Follow all signs and instructions. There is a risk of explosion in places that include areas where you are normally requested to turn off your car engine. In these areas, sparks can cause explosion or fire which can lead to personal injury or even death.

Turn off the unit at filling stations, and any other place that has fuel pumps and auto repair facilities.

Follow the restrictions that apply to the use of radio equipment near places where fuel is stored and sold, chemical factories and places where blasting is in progress. Areas with risk for explosion are often – but not always – clearly marked. This also applies to below decks on ships; the transport or storage of chemicals; vehicles that use liquid fuel (such as propane or butane); areas where the air contains chemicals or particles, such as grain, dust or metal powder.

Li-ion battery

This product contains a Li-ion battery. There is a risk of fire and burns if the battery pack is handled improperly.

 **WARNING**  
Danger of explosion if battery is incorrectly replaced. To reduce risk of fire or burns, do not disassemble, crush, puncture, short external contacts, expose to temperature above 60° C (140° F), or dispose of in fire or water. Recycle or dispose of used batteries according to the local regulations or reference guide supplied with your product.

**Protect your hearing**

 **WARNING**  
Excessive exposure to loud sounds can cause hearing damage. Exposure to loud sounds while driving may distract your attention and cause an accident. Listen to a headset at a moderate level, and do not hold the device near your ear when the loudspeaker is in use.

Emergency calls

**Important!**  
Mobile phones use radio signals, the mobile phone network, the terrestrial network and user-programmed functions. This means that connection cannot be guaranteed in all circumstances. Therefore, never rely only on a mobile phone for very important calls such as medical emergencies.

Vehicles

Radio signals can affect electronic systems in motor vehicles (for example, electronic fuel injection, ABS brakes, automatic cruise control, air bag systems) that have been incorrectly installed or are inadequately protected. Contact the manufacturer or its representative for more information about your vehicle or any additional equipment.

Do not keep or transport flammable liquids, gases or explosives together with the unit or its accessories. For vehicles equipped with air bags: Remember that air bags fill with air with considerable force. Do not place objects, including fixed or portable radio equipment in the area above the airbag or the area where it might expand. Serious injuries may be caused if the mobile phone equipment is incorrectly installed and the airbag fills with air. It is prohibited to use the unit in flight. Turn off the unit before you board a plane. Using wireless telecom units inside a plane can pose risks to air safety and interfere with telecommunications. It may also be illegal.

17. CARE AND MAINTENANCE

Your unit is a technically advanced product and should be treated with the greatest care. Negligence may void the warranty.

- Protect the unit from moisture. Rain, snow, humidity, and all types of liquids can contain substances that corrode the electronic circuits. If the unit gets wet, you should immediately power off the phone, remove the battery and allow the unit to dry completely before you replace it.
- Do not use or keep the unit in dusty, dirty environments. The unit’s moving parts and electronic components can be damaged.
- Do not keep the unit in warm places. High temperatures can reduce the lifespan for electronic equipment, damage batteries and distort or melt certain plastics.
- Do not keep the unit in cold places. When the unit warms up to normal temperature, condensation can form on the inside and can damage the electronic circuits.
- Do not try to open the unit in any other way than that which is indicated here.
- Do not drop or shake the unit. If it is treated roughly the circuits and precision mechanics can be broken.
- Do not use strong chemicals to clean the unit.
- Do not disassemble, open, crush, bend, deform, puncture or shred.
- Do not modify or remanufacture, attempt to insert foreign objects into the battery, immerse or expose to water or other liquids, expose to fire, explosion or other hazard.

- Only use the battery for the system for which it is specified.
- Only use the battery with a charging system that has been qualified with the system per IEEE-Std-1725. Use of an unqualified battery or charger may present a risk of fire, explosion, leakage, or other hazard.
- Do not short circuit a battery or allow metallic conductive objects to contact battery terminals.
- Replace the battery only with another battery that has been qualified with the system per this standard, IEEE-Std-1725. Use of an unqualified battery may present a risk of fire, explosion, leakage or other hazard.
- Promptly dispose of used batteries in accordance with local regulations.
- Battery usage by children should be supervised.
- Improper battery use may result in a fire, explosion or other hazard.

For devices that utilize a USB port as a charging source, the device’s user manual shall include a statement that the device shall only be connected to CTIA certified adapters, products that bear the USB-IF logo or products that have completed the USB-IF compliance program.

The advice applies to the unit, battery, power adapter and other accessories. If the phone is not working as it should, please contact the place of purchase for service. Don’t forget the receipt or a copy of the invoice.

18. WARRANTY

This product is guaranteed for a period of 24 months from the date of purchase. In the unlikely event of a fault occurring during this period, please contact the place of purchase. Proof of purchase is required for any service or support needed during the guarantee period.

This guarantee will not apply to a fault caused by an accident or a similar incident or damage, liquid ingress, negligence, abnormal usage, non-maintenance or any other circumstances on the user’s part. Furthermore, this guarantee will not apply to any fault caused by a thunderstorm or any other voltage fluctuations. As a matter of precaution, we recommend disconnecting the charger during a thunderstorm.

Batteries are consumables and are not included in any guarantee. This guarantee does not apply if batteries other than DORO original batteries are used.

19. COPYRIGHT AND OTHER NOTICES

© 2016 Doro AB. All rights reserved.  
Bluetooth® is a registered trademark of Bluetooth SIG, inc. eZiType™ is a trademark of Zi Corporation.  
vCard is a trademark of the Internet Mail Consortium.  
microSD is a trademark of SD Card Association.  
The contents of this document are provided “as is”. Except as required by applicable law, no warranties of any kind, either express or implied, including, but not limited to, the implied warranties of merchantability and fitness for a particular purpose, are made in relation to the accuracy, reliability or contents of this document. Doro reserves the right to revise this document or withdraw it at any time without prior notice.

Other product and company names mentioned herein may be the trademarks of their respective owners.

Any rights not expressly granted herein are reserved. All other trademarks are property of their respective owners.

To the maximum extent permitted by applicable law, under no circumstances shall Doro or any of its licensors be responsible for any loss of data or income or any special, incidental, consequential or indirect damages howsoever caused.  
Doro does not provide a warranty for or take any responsibility for the functionality, content, or end-user support of third-party apps provided with your device. By using an app, you acknowledge that the app is provided as is. Doro does not make any representations, provide a warranty, or take any responsibility for the functionality, content, or end-user support of third-party apps provided with your device.

Content copyright

The unauthorised copying of copyrighted materials is contrary to the provisions of the Copyright Laws of the United States and other countries. This device is intended solely for copying non-copyrighted materials, materials in which you own the copyright, or materials which you are authorised or legally permitted to copy. If you are uncertain about your right to copy any material, please contact your legal advisor.

20. TECHNICAL DATA

Specifications

<b>Network bands (MHz)</b>	WCDMA 900 [24] /2100 [24]
<b>[maximum radio-frequency power/dBm]:</b>	GSM 900 [33] / 1800 [30] / 1900 [30]
<b>Bluetooth (GHz) [maximum radio-frequency power/dBm]:</b>	2.1 + EDR (2.4) [10]
<b>Dimensions:</b>	128 mm x 51 mm x 12 mm
<b>Weight:</b>	90 g (including battery)
<b>Battery:</b>	3.7 V / 800 mAh Li-ion battery
<b>Operating ambient temperature:</b>	Min: 0°C (32°F) Max: 40°C (104°F)
<b>Charging ambient temperature:</b>	Min: 0°C (32°F) Max: 40°C (104°F)
<b>Storage temperature:</b>	Min: -20°C (-4°F) Max: 60°C (140°F)

Hearing aid

This device should work with most hearing aid equipment in the market. However, full compatibility with all equipment can not be promised.

Specific Absorption Rate (SAR)

This device meets applicable international safety requirements for exposure to radio waves. Your mobile device is a radio transmitter and receiver. It is designed not to exceed the limits for exposure to radio waves (radio frequency electromagnetic fields) recommended by international guidelines from the independent scientific organization ICNIRP (International Commission of Non-Ionizing Radiation Protection).

The radio wave exposure guidelines use a unit of measurement known as the Specific Absorption Rate, or SAR. The SAR limit for mobile devices is 2 W/kg averaged over 10 grams of tissue and include a substantial safety margin designed to assure the safety of all persons, regardless of age and health.

Tests for SAR are conducted using standard operating positions with the device transmitting at its highest certified power level in all tested frequency bands. The highest SAR values under the ICNIRP guidelines for this device model are:

Head SAR: 1.029 W/kg



Body SAR: 1.735 W/kg

During normal use, the SAR values for this device are usually well below the values stated above. This is because, for purposes of system efficiency and to minimize interference on the network, the output power of your mobile device is automatically decreased when full power is not needed for the call. The lower the power output of the device, the lower its SAR value.

This device meets RF exposure guidelines when used against the head or when positioned at least 0.5 cm away from the body. When a carry case, belt clip or other form of device holder is used for body-worn operation, it should not contain metal and should provide at least the above stated separation distance from the body.

The World Health Organization (WHO) has stated that current scientific information does not indicate the need for any special precautions when using mobile devices. If you are interested in reducing your exposure, they recommend you reduce your usage or use a hands-free accessory to keep the device away from your head and body.

Correct disposal of this product

 (Waste Electrical & Electronic Equipment)  
 (Applicable in countries with separate collection systems)

This marking on the product, accessories or manual indicates that the product and its electronic accessories (e.g. charger, headset, USB cable) should not be disposed of with other household waste. To prevent possible harm to the environment or human health from uncontrolled waste disposal, please separate these items from other types of waste and recycle them responsibly to promote the sustainable reuse of material resources.

Household users should contact either the retailer where they purchased this product, or their local government office, for details of where and how they can take these items for environmentally safe recycling.

Business users should contact their supplier and check the terms and conditions of the purchase contract. This product and its electronic accessories should not be mixed with other commercial wastes for disposal. This product is RoHS compliant.

Correct disposal of batteries in this product

 (Applicable in countries with separate collection systems)

The marking on the battery, manual or packaging indicates that the battery in this product should not be disposed of with other household waste. Where marked, the chemical symbols Hg, Cd or Pb indicate that the battery contains mercury, cadmium or lead above the reference levels in EC Directive 2006/66. If batteries are not properly disposed of, these substances can cause harm to human health or the environment. To protect natural resources and to promote material reuse, please separate batteries from other types of waste and recycle them through your local, free battery return system.

Declaration of Conformity

Hereby, Doro declares that the radio equipment type DFB-0070 (**Doro 5516**) is in compliance with Directives: 2014/53/EU and 2011/65/EU. The full text of the EU declaration of conformity is available at the following internet address: [www.doro.com/dofc](http://www.doro.com/dofc).

Ecodesign declaration, energy efficiency for external power supply

Hereby, Doro declares the external power supply for this device is in compliance with Commission Regulation (EU) 2019/1782 regarding ecodesign requirements for external power supplies pursuant to Directive 2009/125/EC.

The full information regarding the ecodesign requirements is available at the following internet address: [www.doro.com/ecodesign](http://www.doro.com/ecodesign)

Model: DFB-0070  
Doro 5516 (2011, 2021)  
QSG  
English



QSG\_Doro\_5516\_en\_A3-A7\_FSC\_v32

[www.doro.com](http://www.doro.com)

